

Note:

- Existing Ledger Board is a PT 2x10
- PT Posts are 6x6's 9'6" On Center
- PT Beams are Double 2x12s
- PT Beams are Bolted to the Notched Posts
- PT Joists are 2x10s 12" On Center
- All Joists are Simpson Tied to each Beam
- 2-3 Rows of Blocking are installed
- 1x6 Composite Decking Boards
- White vinyl composite railing

Hank & Gina Ashforth
 522 South Riverside Drive
 Neptune, NJ 07753

DIAGRAM FOR DECK FOOTING

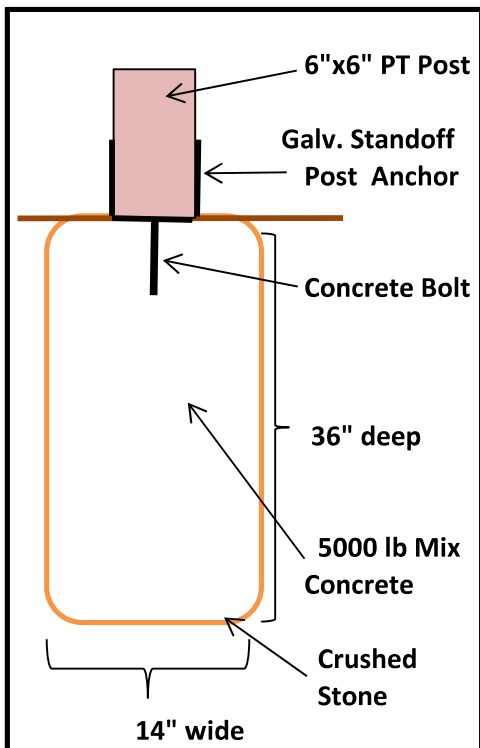

DIAGRAM FOR DECK STRUCTURE

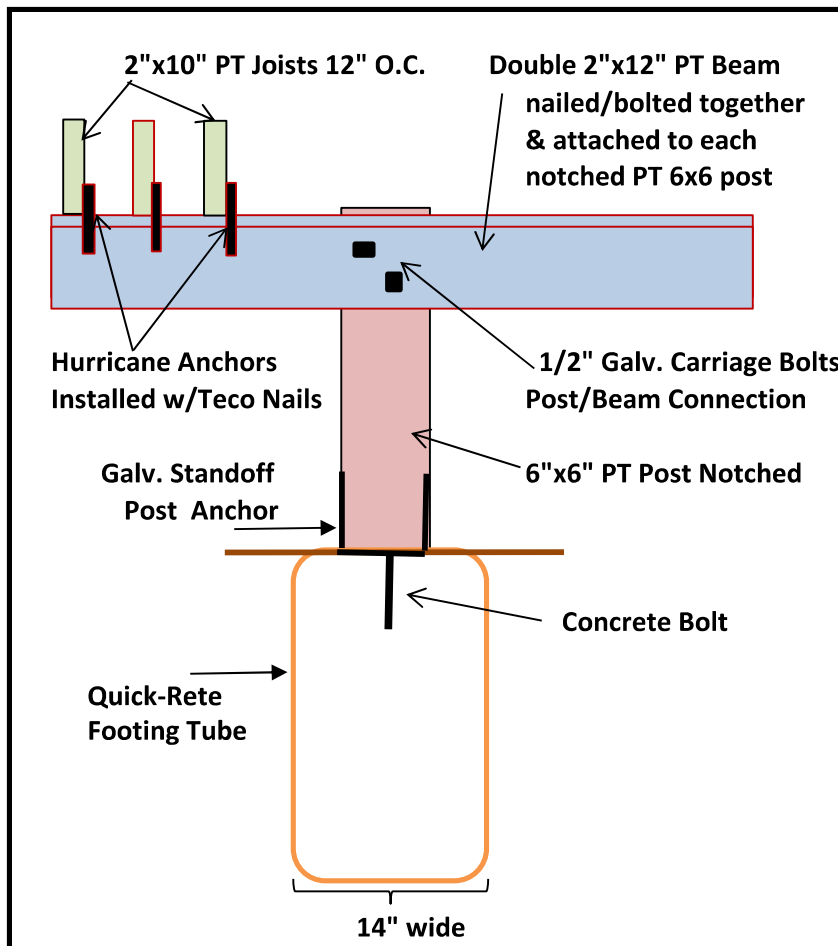
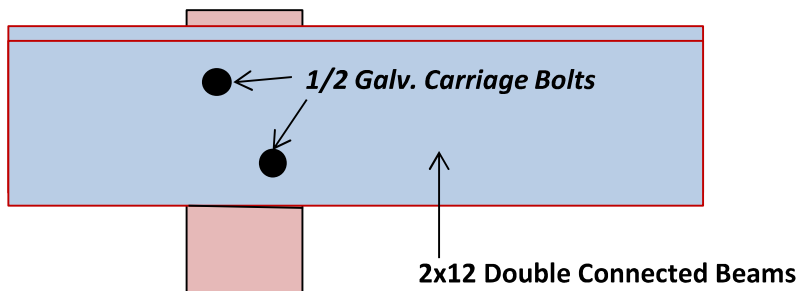
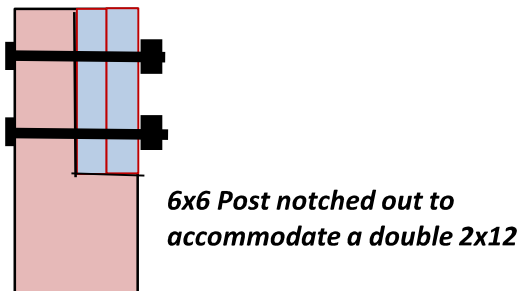
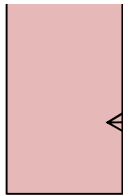

DIAGRAM POST TO BEAM CONNECTION



SIDE VIEW POST TO BEAM CONNECTION





6"x6" PT Post Notched



1/2" Galv. Carriage Bolts
w/washers & nuts

WOLF DECK RAILING - WHITE COMPOSITE VINYL RAILINGS



WOLF DECK STAIR RAILING



- NOTE: DECK RAILINGS WILL MEET ALL LOCAL BUILDING AND MANUFACTURE CODE.**
- NOTE: RAILING POSTS WILL BE BOLTED & BLOCKED TO DECK STRUCTURE.**
- NOTE: RAILINGS WILL BE INSTALLED AROUND PERIMETER OF THE DECK.**
- NOTE: MATCHING RAILING WILL BE INSTALLED ON THE SIDES OF THE STAIRS.**
- NOTE: ADA COMPLIANT RAILING INSTALLED ON 1 SIDE OF THE STAIR RAILINGS.**

DECK STAIR STRINGERS

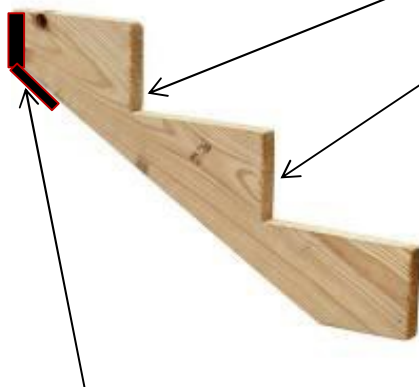

- STRINGERS INSTALLED EVERY 12" O.C.**
- PROPER RISE (~8") & TREADS (~12") ON EACH STEP TO MEET ALL LOCAL BUILDING CODES.**
- ~ APPROX. 30"-36" FROM GROUND TO DECK HEIGHT.**
- STRINGERS WILL BE RESTING ON A CEMENT PAD.**

COMPOSITE DECK STAIRS



AN ADI COMPLIANT SAFETY HAND RAIL WILL BE INSTALLED ON 1 SIDE OF STAIRS.

SIMPSEN ZMAX STAIR STRINGER SUPPORT

**Hank & Gina Ashforth
522 South Riverside Drive
Neptune, NJ 07753
24'x20' & 16x18 Deck
Block: 5213 Lot: 1V1.0**

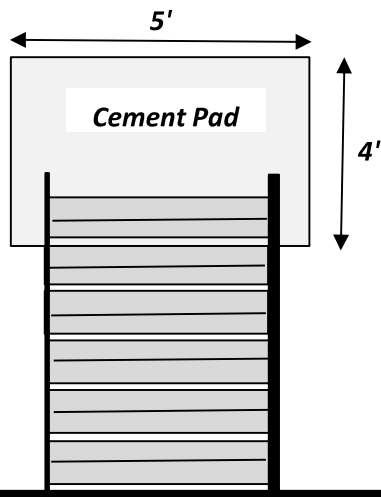

**4' Wide Stairs coming
off of Lower Deck
approx 30"-36" off ground
and a 2nd set of stairs also 4' wide
leading from the upper deck to the lower deck.**

**Note: 4' wide Stairs w/proper
rise (~8") & tread (~12")
to meet local building code
~ Stairs will be fully enclosed
~ Stair stringers are 12" O.C.
~ Simpson Zmax stringer supports
~ Stair railing on each side of steps
~ Deck is approx. ~30"-36" off the
~ ADA Safety rail installed on 1 side**

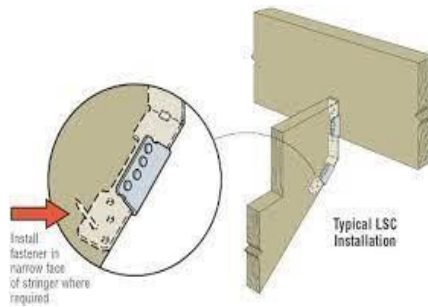

**Hank & Gina Ashforth
522 South Riverside Drive
Neptune, NJ 07753
24'x20' & 16x18 Deck
Block: 5213 Lot: 1V1.0**