

EXHIBIT C

SUPPLEMENTAL ATTACHMENT

SPECIFICATION SHEETS TO

SUPPLEMENT EXHIBIT B



Russo Seamless Gutter, LLC

estimates@russogutter.com

5100 NJ- 33

Farmingdale, NJ 07727

Contractor License #: Lic # 13VH00268100

Hi Robert Tice!

GUTTERS (732) 751-8870

Job Address: 98 Lawrence Avenue Neptune Township, NJ 07756

Accept Re Print (<https://jobprogress.com/api/public/proposals/1746648265681bbcc9c4af7/file>)

Download <https://jobprogress.com/api/public/proposals/1746648265681bbcc9c4af7/file?download=1>

**SEAMLESS GUTTER, LLC
& EXTERIORS**
"We're More Than Just Gutters"
5100 NJ-33 Farmingdale, NJ 07727 | Phone: 732-751-8870 | Website: russogutter.com

**GAF Certified**
Weather Shaper Roofing Contractor

SINCE 1997
20 YEARS

NAME

Robert Tice

ADDRESS

98 Lawrence Avenue

CITY

STATE

ZIP

EMAIL

Neptune Township

New Jersey

07756

bobtice1@verizon.net

HOME:

CELL:

(732) 904-2469

(732) 904-2469

DATE

05/07/2025

Please review the estimate below.

Feel free to contact us if you have any questions or concerns.

We look forward to working with you.

Safety is our Goal, Our Technicians are OSHA 10 certified

7:22



hover_pro_measurements_...



PDF - 1.3 MB

Roof	Facets	Total
Labeled Facets	7	1088 ft²
Small Facets	2	0 ft²
Total	9	1088 ft²

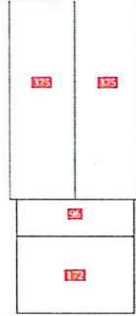

Hover

© 2023 HOVER and all rights reserved. This document contains measurement data, labels and other information that is the property of HOVER. HOVER is the registered trademark of HOVER Inc. All other brands, products and company names mentioned herein may be trademarks or registered trademarks of their respective holders. Use of this document is subject to HOVER's Terms of Use and is provided as is. HOVER makes no warranties, representations or assertions of any kind, express or implied, arising from the use of this document or the data contained herein, including but not limited to, accuracy, completeness, reliability, or fitness for a particular purpose.

PROPERTY ID: R22054
MODEL ID: R22054
NAME: TOCONITA RA ARCH
3 APR 2023
Page 24

Hover

Complete Measurements

Mark Toconita RA Architecturals ...
ROOF PITCH

Roof Pitch	Area	Percentage
10 / 12	756 ft²	69.64%
4 / 12	172 ft²	14.48%
5 / 12	157 ft²	13.22%
1 / 12	96 ft²	8.08%
6 / 12	7 ft²	0.59%

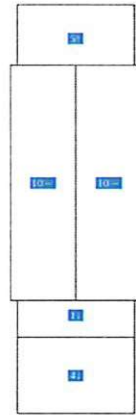

Hover

© 2023 HOVER and all rights reserved. This document contains measurement data, labels and other information that is the property of HOVER. HOVER is the registered trademark of HOVER Inc. All other brands, products and company names mentioned herein may be trademarks or registered trademarks of their respective holders. Use of this document is subject to HOVER's Terms of Use and is provided as is. HOVER makes no warranties, representations or assertions of any kind, express or implied, arising from the use of this document or the data contained herein, including but not limited to, accuracy, completeness, reliability, or fitness for a particular purpose.

PROPERTY ID: R22054
MODEL ID: R22054
NAME: TOCONITA RA ARCH
3 APR 2023
Page 25

Hover

Complete Measurements

Mark Toconita RA Architecturals ...
PHOTOS

Open M365 Copilot



7:22



5G

hover_pro_measurements_...

PDF - 1.3 MB

Roof	Area	Total
Roofed Surface	72.42	158.85
Roofed Surface	2	0.42
Total	9	158.85

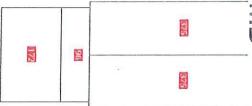

Hover

Complete Measurements

Mark Toconita RA Architectural ...
Roof Pitch

Roof Pitch	Area	Percentage
0/12	72.42	63.64%
1/12	72.42	14.48%
5/12	12.42	14.48%
1/2	16.42	8.42%
5/12	7.42	0.59%



Hover

Complete Measurements

Mark Toconita RA Architectural ...
Roof Pitch

Open M365 Copilot



[Back to Parent](#)

Timberline HDZ®

[Find a contractor](#)

[Find a Contractor](#)



All Products

Your Area



Pewter
Gray



Appalachian
Sky



Barkwood



Birchwood



Biscayne
Blue



Cedar Falls



Charcoal



Copper
Canyon



Drift

[Jump to
Overview](#)

About Timberline HDZ® Shingles

Hardie® Plank Lap Siding

Submittal Form

01

Submitted to:

Project Name:

Submitted by:

Date:

☐ HZ5® Product Zone ☐ HZ10® Product Zone

 Product Width: ☐ 5-1/4in ☐ 6-1/4in ☐ 7-1/4in ☐ 8in ☐ 8-1/4in ☐ 9-1/4in ☐ 12in

 Product Finish: ☐ Primed ☐ ColorPlus® Technology

 Product Texture: ☐ Smooth ☐ Select Cedarmill® ☐ Colonial Roughsawn®
 ☐ Colonial Smooth® ☐ Rustic Cedar

Hardie® Plank Lap Siding

Specification Sheet

01

DIVISION: 07 00 00 THERMAL AND MOISTURE PROTECTION

SECTION: 07 46 46 FIBER CEMENT SIDING

HARDIE® PLANK LAP SIDING

Manufacturer

James Hardie Building Products, Inc.

The products are manufactured at the following locations, with quality control inspections by ICC-ES:

- Cleburne, Texas
- Plant City, Florida
- Reno, Nevada
- Waxahachie, Texas
- Prattville, Alabama
- Peru, Illinois
- Pulaski, Virginia
- Tacoma, Washington
- Fontana, California
- Summerville, South Carolina

Compliance with the following codes

- 2006 thru 2021 International Building Code (IBC)
- 2006 thru 2021 International Residential Code (IRC)

For more information about other compliances and applicable uses, refer to ICC-ES ESR-2290

Features

- Noncombustible
- Dimensionally Stable
- Resists damage from pests
- Weather Resistant-Engineered for Climate®
- Impact resistant
- Sustainable

Use

Hardie® fiber-cement lap siding is used as exterior wall covering. The product complies with IBC Section 1403.9 and IRC Section R703.10. The product may be used on exterior walls of buildings of Type I, II, III and IV construction (IBC)

Description

Hardie® Plank lap siding is a single-faced, cellulose fiber-reinforced cement (fiber-cement) product. Hardie® Plank lap siding complies with ASTM C1186, as Grade II, Type A; has a flame-spread index of 0 and a smoke-developed index of 5 when tested in accordance with ASTM E84; and is classified as noncombustible when tested in accordance with ASTM E136.

Available Sizes

Product	Width (in)	Length	Thickness (in)
Hardie® Plank lap siding*	5-1/4, 6-1/4, 7-1/4, 8, 8-1/4, 9-1/4, 12	12 feet	5/16

* HZ5: 9-1/4, 12 only available primed HZ10: 5-1/4, 9-1/4, 12 only available primed.

Weight 2.31 lbs. per square foot

Texture & Finish

Hardie® Plank lap siding comes in a variety of textures and finishes. The product is available in smooth or wood grain texture. Additional textures are available on a regional basis. Finish options are primed for field paint, or factory finished with ColorPlus® Technology. Color availability varies by region.

Engineered for Climate®

Hardie® Plank lap siding is engineered for performance to specific weather conditions by climate zones as identified by the following map.



SPECIFICATION SHEET 01 FEBRUARY 2024

Performance Properties

	General Property	Test Method	Unit or Characteristic	Requirement	Result
PHYSICAL ATTRIBUTES	Dimensional Tolerances	ASTM C1185	Length	± 0.5% or ± 1/4 in	Pass
			Width	± 0.5% or ± 1/4 in	
			Thickness	± 0.04 in	
			Squareness	Δ in diagonals ≤ 1/32 in/ft of sheet length. Opposite sheet sides shall not vary in length by more than 1/32 in/ft	
			Edge Straightness	≤ 1/32 in/ft of length	
	Density, lb/ft³	ASTM C1185		As reported	83
	Water Absorption, % by mass	ASTM C1185		As reported	36
THERMAL	Water Tightness	ASTM C1185	Physical Observations	No drop formation	Pass
	Flexural Strength	ASTM C1185	Wet conditioned, psi	>1015 psi	Pass
			Equilibrium conditioned, psi	>1450 psi	
	Thermal Conductivity	ASTM C177	(BTU/(hr·ft²·F))/inch	As reported	2.07
	Actual Thermal Conductivity		(K _{cs})		6.62
Thermal Resistance	R=1/ K _{cs}		0.48		
DURABILITY	Actual Thermal Resistance		(R)		0.15
	Warm Water Resistance	ASTM C1185	Physical Observations	No visible cracks or structural alteration	Pass
	Heat/Rain Resistance	ASTM C1185	Physical Observations	No visible cracks or structural alteration	Pass
	Freeze/Thaw Resistance	ASTM C1185	Physical Observations	No visible cracks or structural alteration	Pass
			Mass Loss, %	≤ 3.0%	
FIRE CHARACTERISTICS			Freeze/Thaw, % strength retention	≥ 80%	
	UV Accelerated Weathering Test	ASTM G23	Physical Observations	No cracking, checking, or crazing	Pass
	Surface Burning Characteristics	ASTM E84	Flame Spread Index (FSI)		0
			Smoke Developed Index (SDI)		≤ 5
			Fuel Contributed		0
			NFPA Class		A
			Uniform Building Code Class	As reported	1
		International Building Code® class		A	
Noncombustibility	ASTM E136	Noncombustible	Pass/fail	Pass	
Fire Resistance Rated Construction	ASTM E119	Fire Resistance Rating	1-hour	Note 1	

Note 1: listed on Warnock Hersey and ESR 2290

Installation

Install Hardie® Plank lap siding in accordance with:

- Hardie® Plank lap siding installation instructions
- ICC-ES ESR 2290
- Requirements of authorities having jurisdiction

Warranty

Hardie® Plank lap siding: 30-year, Non-Prorated, Limited Warranty
ColorPlus® Technology: 15-year Limited Finish Warranty

Sustainable Design Contribution

- Regionally sourced content- varies by project location
- Avoidance of certain chemicals or Red List Compliance

Detailed product information for LEED projects, or other state or regional sustainability programs is available through James Hardie Technical Services.

Storage and Handling

Store flat and keep dry and covered prior to installation.

Technical Services

Contact James Hardie Technical Services online at JamesHardie.com, or by phone at (800)426-4051

SS2001 02/24 PAGE 2 OF 2

IMPORTANT: Failure to install and finish this product in accordance with applicable building codes and James Hardie's written application instructions may affect system performance, violate local building codes, void the product-only warranty and lead to personal injury. **DESIGN ADVICE:** Any information or assistance provided by James Hardie in relation to specific projects must be approved by the relevant specialists engaged for the project eg. builder, architect or engineer. James Hardie will not be responsible in connection with any such information or assistance.

© 2024 James Hardie Building Products, Inc. All rights reserved TM, SM and ® denote trademarks or registered trademarks of James Hardie Technology Limited. The International Building Code and International Residential Code trademarks are registered trademarks of International Code Council, Inc.

Product warranties, safety information and additional installation information are available at jameshardiepros.com
1 866 442 7343 | www.jameshardie.com

