

Township of Neptune
 Monmouth County, NJ
 Tax Map No. 7
 Certified April 8, 2014

- Subject Property
- Commercial
- Medical
- Residential
- Automotive
- Vacant and/or City Owned

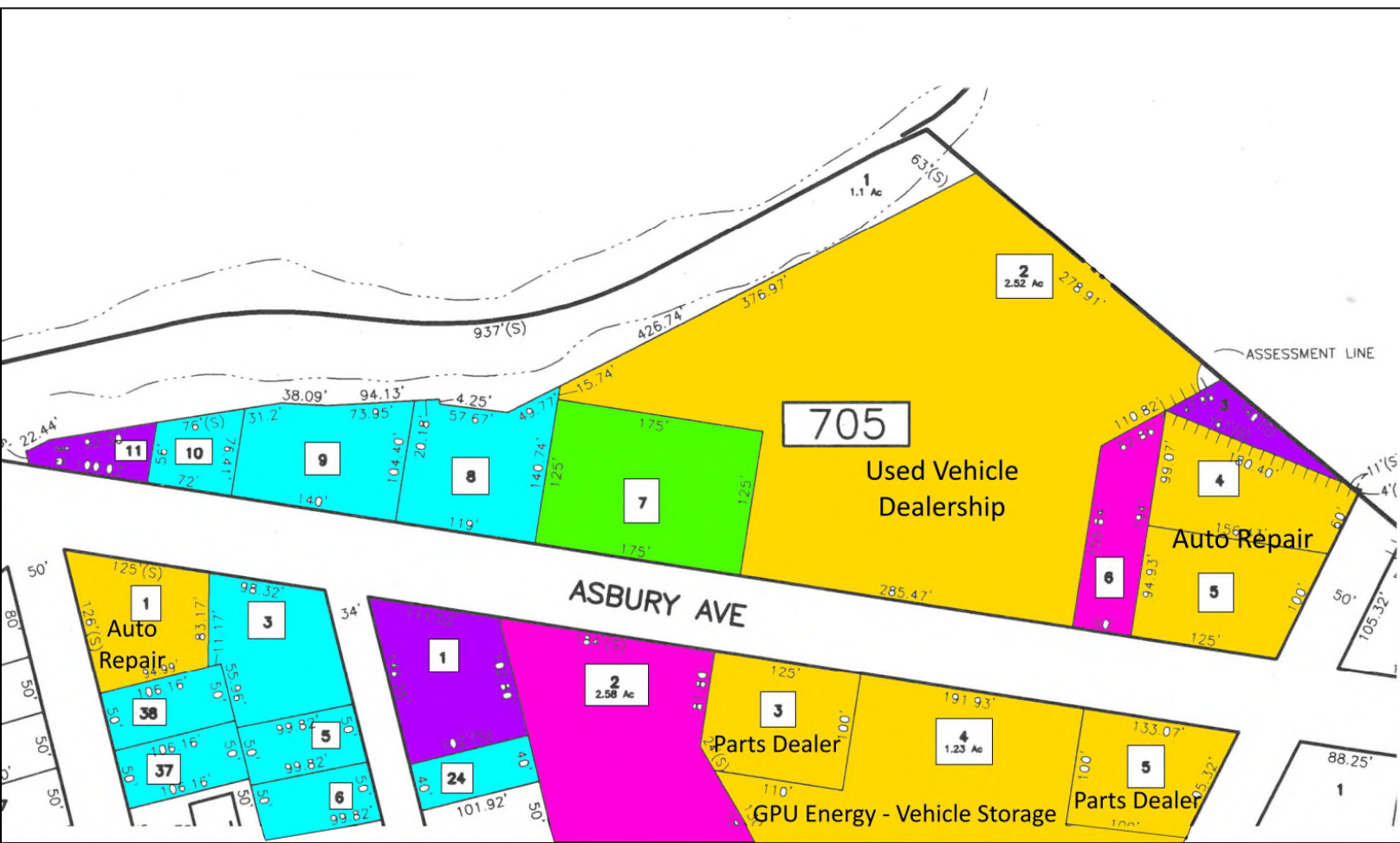



1729 Asbury Avenue
Block 187, Lot 5
Neptune Township, New Jersey

Beacon Planning and Consulting Services, LLC
315 Route 34 - Suite 129
Colts Neck, New Jersey 07722





07.22.2020

A-3

Subject Property
1729 Asbury Avenue



07.22.2020

A-4

1701 Asbury Avenue
Block 705, Lots 4 and 5



ASBURY PARK ANIMAL HOSPITAL

1707

07.22.2020

1707 Asbury Avenue
Block 705, Lot 6

A-5



mb motorsports
Auto Service Center
132-878-4882

TOYOTA HONDA MAZDA SUBARU KIA BMW INFINITI RYSLER JAGUAR

PORSCHE

07.22.2020

A-6

1715 Asbury Avenue
Block 705, Lot 2



LHS
732-802-5200

ELTA

5000
AAA
Prestige

LAMB

07.22.2020

1715 Asbury Avenue
Block 705, Lot 2

A-7



07.22.2020

1733 Asbury Avenue
Block 705, Lot 8

A-8



Norwood AUTO PARTS

NORWOOD
AUTO PARTS
Deka
BATTERIES

07.22.2020

1718 Asbury Avenue
Block 704, Lot 3

A-9



07.22.2020

A-10

Asbury Avenue
Block 704, Lot 4



ASBURY AVE

NAPA
AUTO & TRUCK PARTS

NAPA

1700

NAPA
AUTO & TRUCK PARTS

07.22.2020

1700 Asbury Avenue
Block 704, Lot 5

A-11



732-897-9966

TONY MOTORS, INC.

07.22.2020

1828 Asbury Avenue
Block 703, Lot 1

A-12

Auto Repair and Gasoline Service Stations

1. Gulf - 3655 Route 33
2. 76 - 3530 Route 33
3. Gulf - 2439 Route 33
4. Delta - 1800 Route 33
5. Subject Property
6. Quality Service Center - 708 Route 35
7. Sunoco - 3240 Belmar Blvd.

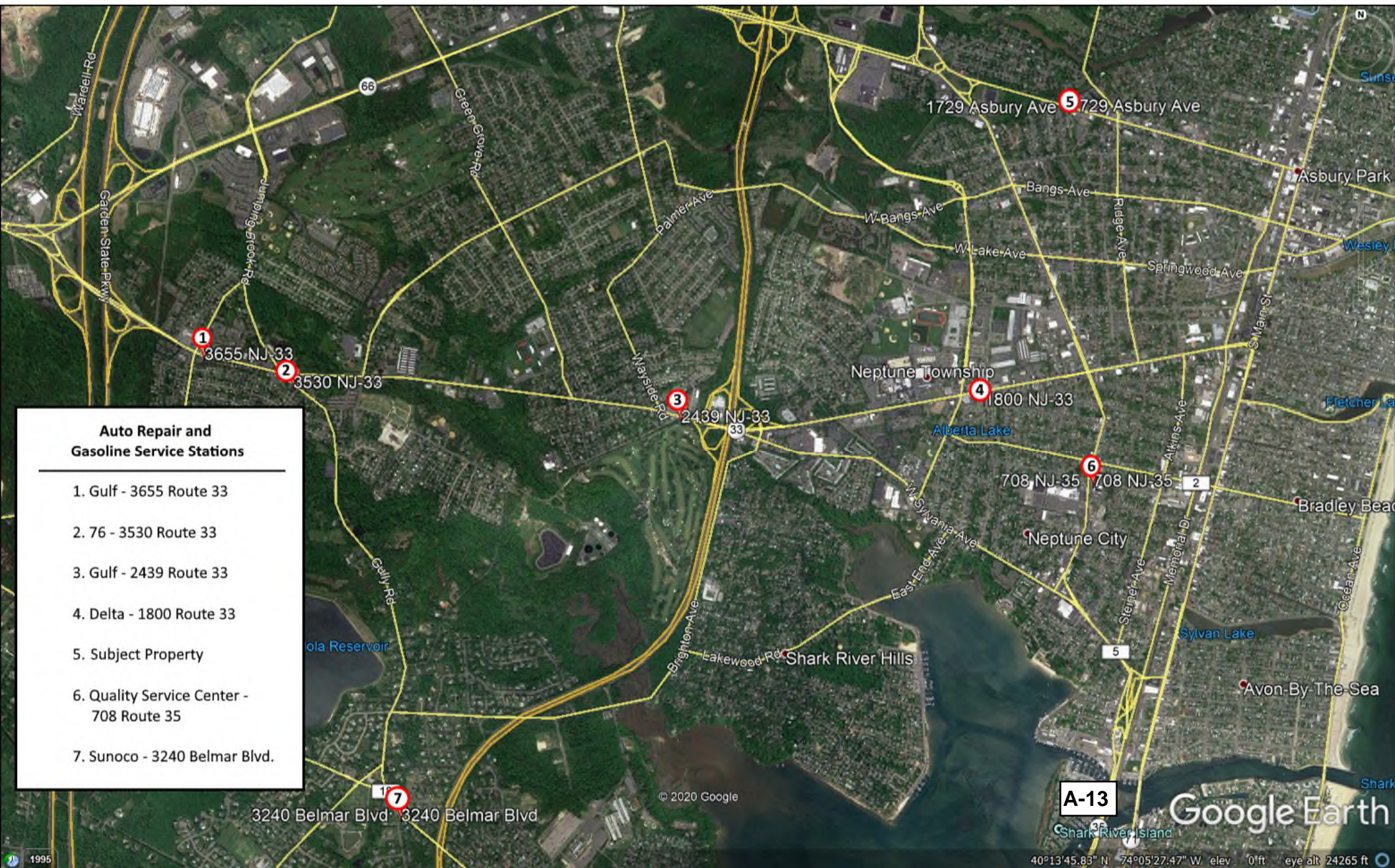

A-13

Google Earth

40°13'45.83" N 74°05'27.47" W elev. 0'ft eye alt. 24265 ft