

1. FIELD WORK PERFORMED BY COLLIER ENGINEERING & DESIGN ON FEBRUARY 28, 2025.
2. THIS IS NOT A BOUNDARY SURVEY. LOT LINES SHOWN HEREON ARE APPROXIMATE PER MONMOUTH COUNTY GIS SPATIAL DATA NETWORK AND SCALED FROM MUNICIPAL TAX MAPS.
3. PROPERTY KNOWN AS A PORTION OF LOT 5, BLOCK 1.01 TAX MAP SHEET NO. 3 OF TOWNSHIP OF NEPTUNE, MONMOUTH COUNTY, STATE OF NEW JERSEY.
4. SUBSURFACE UTILITY NOTES:

- a. THE UNDERSIGNED PROFESSIONAL IS NOT RESPONSIBLE FOR THE PRESENCE OF UNDERGROUND UTILITIES OR STRUCTURES IF SAME ARE NOT VISIBLE OR OTHERWISE DISCLOSED BY ANY OF THE ABOVE DATA.
  - b. UNDERGROUND UTILITIES WERE MAPPED USING RADIO FREQUENCY PIPE AND CABLE DESIGNATING EQUIPMENT AND GROUND PENETRATING RADAR (GPR), OTHER BURIED UTILITIES MAY BE PRESENT BUT WERE NOT DETECTED DUE TO LIMITATIONS OF THE EQUIPMENT. UNFAVORABLE SOIL CONDITIONS, SITE ACCESS, AND/OR SUEILITY INFRASTRUCTURE. THEREFORE, 100% DETECTION IS NOT GUARANTEED. CAUTION SHOULD BE USED WHEN EXCAVATING IN THE VICINITY OF MAPPED FEATURES.
  - c. PLOTTED UTILITY POSITIONS REPRESENT LOCATION OF MOST APPROPRIATE INTERPRETTED GEOGRAPHICAL RESPONSE. THIS RESPONSE IS GENERALLY PRESENT OVER THE TOP CENTER OF THE UTILITY AND MAY BE LOCATED AT VARYING DEPTHS DEPENDING ON SIGNAL QUALITY AND THE EFFECTS OF LOCAL INTERFERENCE. FEATURE MAY BE WIDER THAN PLOTTED LINE (E.G. DUCT BANKS, LARGE CONDUIT).
- UTILITIES MAY BE INSTALLED WITHIN A DUCT BANK, DUE TO THE LIMITATIONS OF GEOPHYSICAL EQUIPMENT AND THE LOCATION OF FEATURES WITHIN THE DUCT BANK. THE ACTUAL HORIZONTAL AND VERTICAL DIMENSIONS OF THE DUCT BANK SYSTEM (AS OBSERVED IN GEOPHYSICAL DATA) MAY VARY.
- e. DUE TO VARYING SOIL CONDITIONS, POSSIBLE CHANGES IN WATER CONTENT, AND OTHER FACTORS, SOME UNDERGROUND UTILITIES COULD NOT BE TRACED ENTIRELY WITHIN THE PROJECT LIMITS. THE UTILITY MAY CONTINUE, BUT SINCE IT WAS NOT OBSERVED IN THE GEOGRAPHICAL DATA BEYOND THESE POINTS, IT COULD NOT BE MAPPED.
- UNDERGROUND UTILITIES SHOWN WERE PLOTTED BASED ON THE INVESTIGATION RESULTS OBTAINED WITH THE DESIGNATING EQUIPMENT AND IN SOME INSTANCES, EXISTING CLIENT-PROVIDED MAPPING. MAPPING SHOWN ON A SUE SKETCH FOR "OCEAN GROVE RESTROOM FACILITIES" PREPARED BY JOSEPH KING, CPS OF COLLIER ENGINEERING & DESIGN IN FEBRUARY 28, 2025.
5. HORIZONTAL DATUM = NORTH AMERICAN DATUM OF 1983 (NAD 83) (NEW JERSEY STATE PLANE COORDINATE SYSTEM)  
VERTICAL DATUM = NORTH AMERICAN VERTICAL DATUM OF 1988 (NAVD 88)  
THE NEW JERSEY STATE PLANE COORDINATE SYSTEM (N.J. S.P.C.S.) WAS ESTABLISHED AT THE PROJECT SITE BASED ON GPS OBSERVATIONS USING NATIONAL GEODETIC SURVEY MONUMENT STAMPED "85 2337 C TIDAL" PID KVG625E, ELEV. 11.37 NAD 1983(1996) AS A BASE STATION.
  6. THE UNDERSIGNED PROFESSIONAL IS NOT QUALIFIED TO DETERMINE THE EXISTENCE OR NONEXISTENCE OF WETLANDS AND/OR TOXIC WASTES. THEREFORE IT SHOULD NOT BE ASSUMED OR CONSTRUED THAT ANY STATEMENT IS BEING MADE BY THE FACT THAT NO EVIDENCE OF WETLANDS OR TOXIC WASTES IS PORTRAYED HEREIN. IT IS IN THE BEST INTEREST OF THE CLIENT TO PURSUE THESE MATTERS AS SEPARATE CONCERNS APART FROM THIS SURVEY.
  7. THE SITE IS LOCATED WITHIN ZONE VE ELEV. 12 - COASTAL FLOOD ZONE WITH VELOCITY HAZARD (WAVE ACTION); BASE FLOOD ELEVATIONS DETERMINED ALSO BEING WITHIN (A SPECIAL FLOOD HAZARD AREAS) SUBJECT TO INUNDATION BY THE 1% ANNUAL CHANCE; THE 1% ANNUAL FLOOD 100-YEAR FLOOD; ALSO KNOWN AS THE BASE FLOOD; IS THE FLOOD THAT HAS A CHANCE OF BEING EQUALED OR EXCEEDED IN ANY GIVEN YEAR. THE SPECIAL FLOOD HAZARD AREA IS THE AREA SUBJECT TO FLOODING BY THE 1% ANNUAL CHANCE FLOOD; AND ZONE X (OTHER AREAS) - AREAS DETERMINED TO BE OUTSIDE THE 0.2% ANNUAL CHANCE FLOODPLAIN, AS SHOWN ON THE SPECIAL FLOOD HAZARD MAP FOR THE COUNTY OF RAMAPOLY COUNTY, NEW JERSEY (ALL JURISDICTIONS), COMMUNITY PANEL NUMBER 34025C 0334, ON EFFECTIVE DATE JUN 15, 2022. PREPARED BY THE FEDERAL EMERGENCY MANAGEMENT AGENCY.
  8. CAUTION: IF THIS DOCUMENT DOES NOT CONTAIN A RAISED IMPRESSION SEAL OR CERTIFIED DIGITAL SEAL OF THE UNDERSIGNED PROFESSIONAL IT IS NOT AN AUTHORIZED ORIGINAL DOCUMENT AND MAY HAVE BEEN ALTERED.

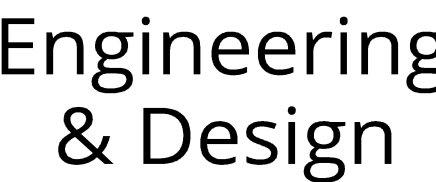
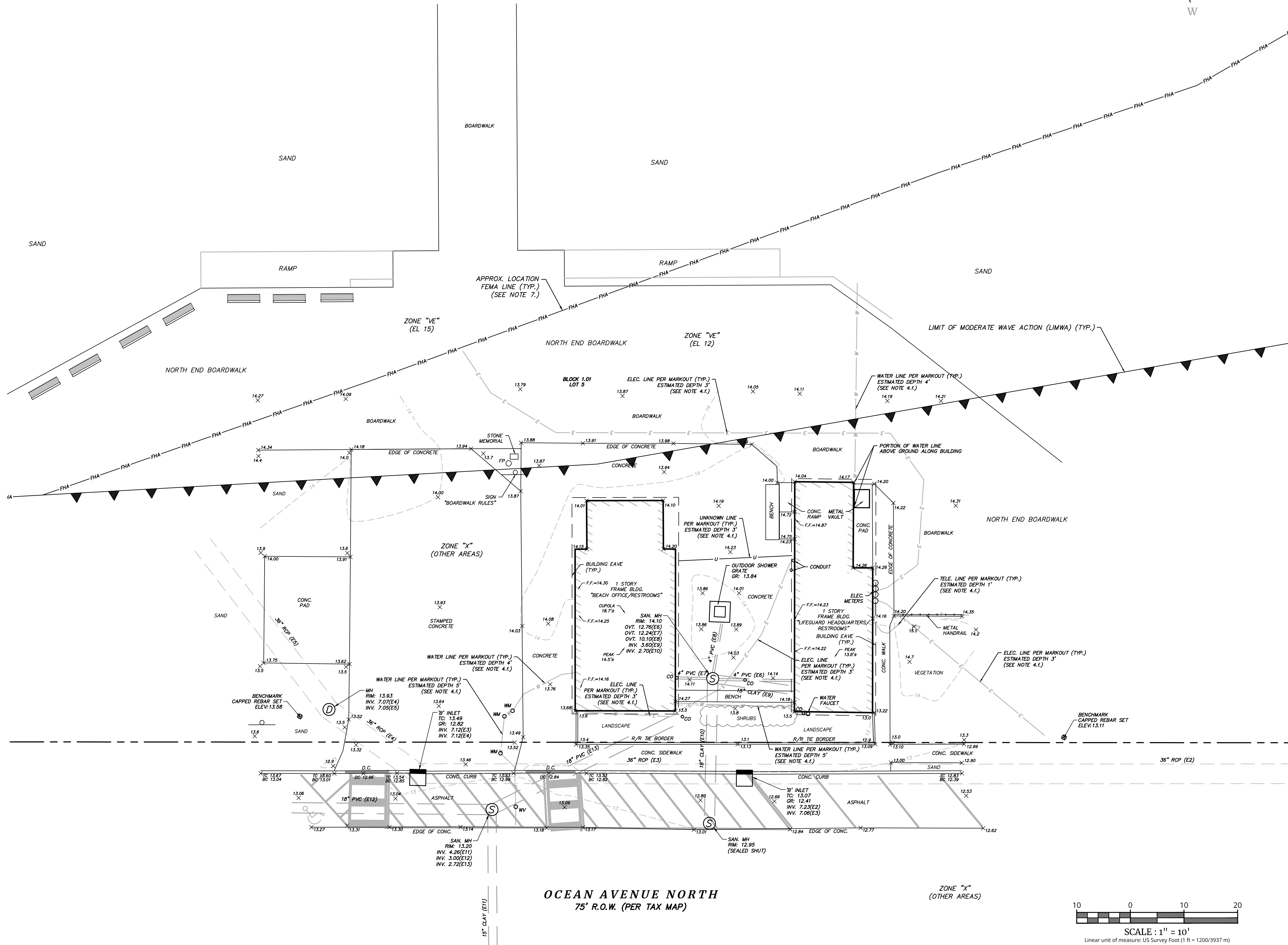
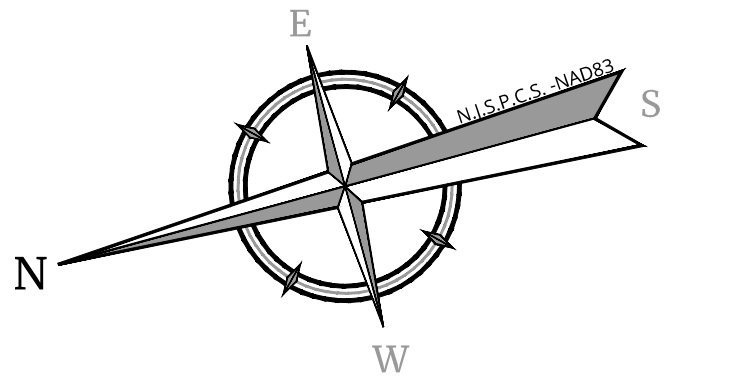
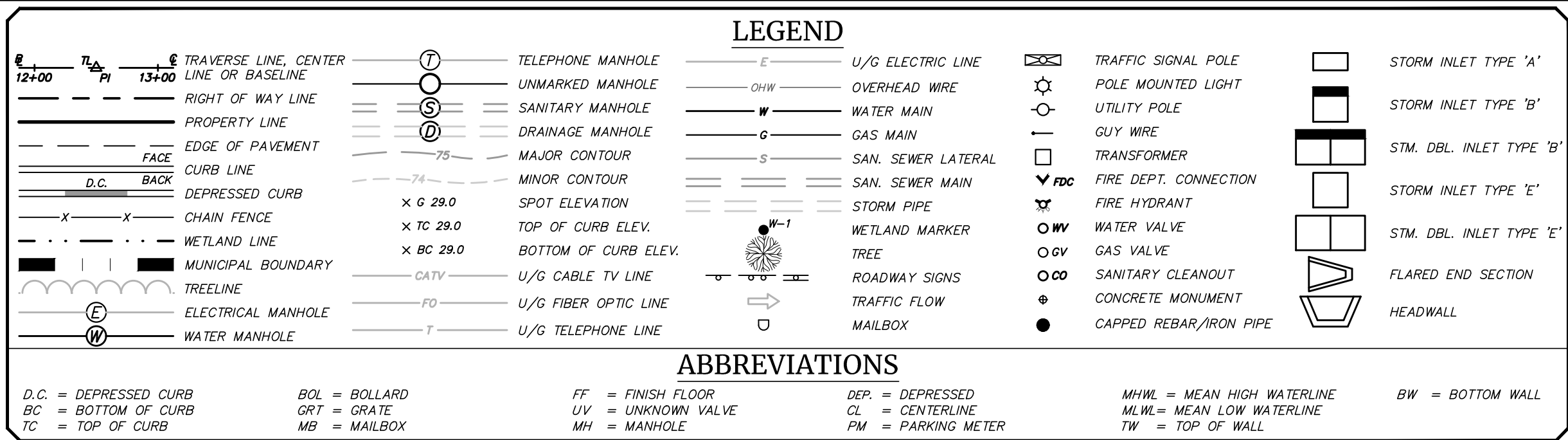
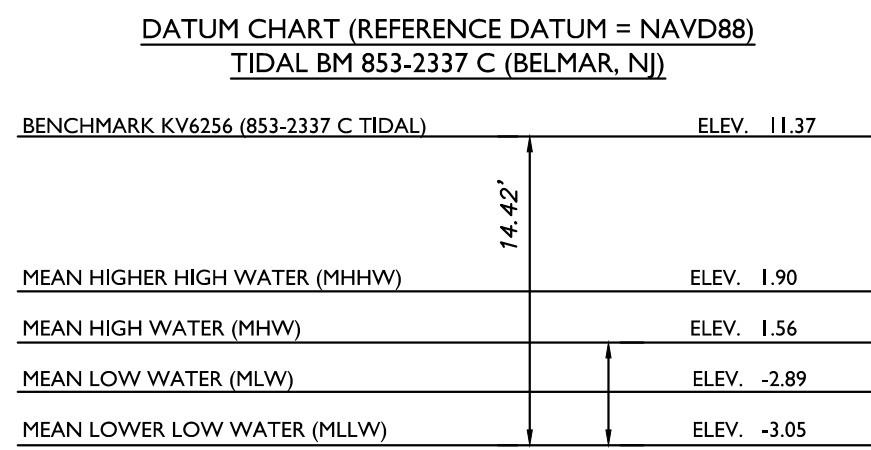

**www.colliersengineering.com**  
Copyright © 2025, Colliers Engineering & Design All Rights Reserved. This drawing and all the information contained herein is authorized for use only by the party for whom the services were contracted or to whom it is certified. This drawing may not be copied, reused, disclosed, distributed or relied upon for any other purpose without the express written consent of Colliers Engineering & Design.

[illegible]

## PROTECT YOURSELF

ALL STATES REQUIRE  
NOTIFICATION OF  
EXCAVATORS, DESIGNERS, OR  
ANY PERSON PREPARING TO  
DISTURB THE EARTH'S SURFACE  
ANYWHERE IN ANY STATE

FOR STATE SPECIFIC DIRECT PHONE NUMBER:  
VISIT: [WWW.CALL811.COM](http://WWW.CALL811.COM)

OCEAN GROVE CAMP  
MEETING ASSOCIATION  
IN NEPTUNE TOWNSHIP

SURVEY/SITE PLAN  
FOR  
OCEAN GROVE  
LIFEGUARD OFFICE AND  
COMFORT STATION  
BLOCK 1.01, LOT 5  
OCEAN GROVE TWP.  
MONMOUTH COUNTY, NJ



Joseph Raftery

NEW JERSEY LICENSED PROFESSIONAL ENGINEER  
 LICENSE NUMBER: GE53339  
 COLLIERS ENGINEERING & DESIGN, INC.  
 N.J. C.O.A. #: 24GA27986500



SCALE:

DESIGNED BY:

DATE ISSUED:

SHEET NAME

DRAWN BY:

ED BY:

NUMBER:

\_\_\_\_\_

## SURVEY/SITE PLAN

DRAWING NUMBER

1

**NOTE: DO NOT SCALE DRAWINGS FOR CONSTRUCTION**